

DATA SHEETS

## Fume cupboard systems

DELTAguard High-performance fume cupboard (DA)



niebeide gleichzeitig öffnen  
both sashes simultaneous

Frontscheibe geschlossen halten.  
horizontal sash closed whenever possible

**Säure  
acid**

## DELTAguard High-performance fume cupboard (DA)

### GENERAL INFORMATION

#### Fundamental safety and performance targets

The fume cupboard is designed in such a way that

- hazardous airborne pollutant concentrations or quantities do not escape from the fume cupboard into the room;
  - hazardous substances are efficiently removed to reduce the risk of formation of an explosive or hazardous atmosphere in the interior of the fume cupboard;
  - the user is protected against splashing and splinters by a front sash.
- The fume cupboards comply with the standards of DIN EN 14175 Parts 1-3 and 7.
  - All fume cupboards are subject to prototype testing by an independent aerotechnical test institute. The fume cupboard emissions have all been far under the limit values of BG Chemie. They meet the safety requirements in all respects.

#### Note:

- Separate types of fume cupboard are available for handling unsealed radioactive substances.

#### The high-performance fume cupboards are sub-divided into:

- fume cupboards for high thermic loads
- perchloric acid fume cupboards for working with perchlorates
- hydrofluoric acid fume cupboards for working with fluorides

### PRODUCT ADVANTAGES

- Fume cupboards for high thermal loads in connection with acid digestions in accordance with DIN EN 14175-7:2012-08
- Worktops and acid-proof, seam-free interior surfaces as required
- Seam-free, moulded flow profile on the worktop
- Large working aperture through narrow guide profiles (pilaster strip)
- Function display integrated in the pilaster strip
- Special air baffles for rapid discharge of thermal loads
- Rear wall duct with direct extraction and optimal sprinkling for working with extreme acid loads
- Conceived for the use of exhaust air scrubbers directly above the fume cupboard
- The standard recommends the use of an exhaust air scrubber
- Modular design with self-supporting rear wall cell, high stability even with individual installation
- Optional: Substructure or hazardous materials/safety cabinet

## DELTAguard High-performance fume cupboard (DA)

### TECHNICAL DATA

			Grid			
			1200	1500	1800	
Dimensions	Width (outer)	mm	1200	1500	1800	
	Depth (outer)	mm	910			
	Height (outer)	mm	2730			
	Width (inner)	mm	1160	1460	1760	
	Depth (inner)	mm	710 (690)			
	Height (inner)	mm	1300			
	Weight	kg (with ceramic lining)		356	401	448
		kg (with ceramic lining)		309	346	385
Interior	Interior surface	Ceramic (SZ)	X			
		Polypropylene (PP)	O			
	Worktop	Stoneware	X			
		Polypropylene (PP)	O			
		Drip cup	rear right (preferred position)	O		
	rear centre		O			
	rear left		O			
Rod holder	without	X				
Front sash	Cross-slider	without	X			
	Operation	manual	X			
		electrical, incl. motion detector	O			
	Design	simple	X			

## DELTAguard High-performance fume cupboard (DA)

		Grid		
		1200	1500	1800
Electrical service outlets	System duct	Electrical service outlets		
		O <sup>2</sup>		
Sanitary service outlets	Service fitting points	in interior (water, gases, vacuum)		
	System duct	Front control valves		
Additional equipment	Substructure	Base cabinet		
	Substructure extraction	O		
	Construction material Class B1	flame resistant		
	Sprinkling of exhaust air duct	O		

X Standard  
O Optional

\*2 Media and electrical service outlets freely selectable

## Fume cupboard for perchloric acid

### TECHNICAL DATA

			Grid			
			1200	1500	1800	
Dimensions	Width (outer)	mm	1200	1500	1800	
	Depth (outer)	mm	910			
	Height (outer)	mm	2730			
	Width (inner)	mm	1160	1460	1760	
	Depth (inner)	mm	710 (690)			
	Height (inner)	mm	1300			
	Weight	kg (with ceramic lining)		356	401	418
		kg (with ceramic lining)		309	346	385
Interior	Interior surface	Ceramic (SZ)	X			
		Polypropylene (PP)	O			
	Worktop	Ceramic (SZ)	X			
		Polypropylene (PP)	O			
		Drip cup	rear right (preferred position)	O		
	rear centre		O			
	rear left		O			
Rod holder	without	X				
Front sash	Cross-slide	without	X			
		Operation	X			
	Design	electrical, incl. motion detector	O			
		simple	X			

## Fume cupboard for perchloric acid

		Grid		
		1200	1500	1800
Electrical service outlets	System duct	Elektrical service outlet		
		O <sup>*2</sup>		
Sanitary service outlets	Service fitting points	in interior (water, gases, vacuum)		
	System duct	Front control valves		
Additional equipment	Substructure	Base cabinet		
	Substructure extraction	O		
	Construction material Class B1	flame-resistant		
	Sprinkling of exhaust air duct	X		

X Standard  
O Optional

\*2 Media and electrical service outlets freely selectable

## Fume cupboard for hydrofluoric acid

### TECHNICAL DATA

			Grid		
			1200	1500	1800
<b>Dimensions</b>	Width (outer)	mm	1200	1500	1800
	Depth (outer)	mm	910		
	Height (outer)	mm	2730		
	Width (inner)	mm	1160	1460	1760
	Depth (inner)	mm	710 (690)		
	Height (inner)	mm	1300		
	Weight	kg (with plastic lining)	309	346	383
<b>Interior</b>	Interior surface	Polypropylene (PP)	X		
	Worktop	Polypropylene (PP)	X		
	Drip cup	rear right (preferred position)	O		
		rear centre	O		
		rear left	O		
Rod holder	without	X			
<b>Front sash</b>	Cross-slide	without	X		
	Operation	manual	X		
		electrical, incl. motion detector	O		
	Design	simple	X		



## Fume cupboard for hydrofluoric acid

		Grid		
		1200	1500	1800
Electrical service outlets	System duct	Elektrical service outlet		
		O <sup>*2</sup>		
Sanitary service outlets	Service fitting points	in interior (water, gases, vacuum)		
	System duct	Front control valves		
Additional equipment	Substructure	Base cabinet		
	Substructure extraction	O		
	Construction material Class B1	flame-resistant		
	Sprinkling of exhaust air duct	O		

- X Standard  
O Optional

\*2 Media and electrical service outlets freely selectable

## DELTAguard High-performance fume cupboard (DA)

### AEROTECHNICAL DATA

Model	Equipment		Grid					
			1200		1500		1800	
			Exhaust air volume   Pressure loss					
			m <sup>3</sup> /h	Pa	m <sup>3</sup> /h	Pa	m <sup>3</sup> /h	Pa
<b>DELTAguard</b> DA-DG03	Exhaust air monitoring (unregulated)	tested	600	61	750	47	900	53
		recomm. V min.	600	61	750	47	900	53
		recomm. V max. <sup>2</sup>	600	61	750	47	900	53
<b>DELTAguard + DELTAcontrol</b> DA-DG03	Constant regulation	tested	600	61	750	47	900	53
		recomm. V min. <sup>1</sup>	600	61	750	47	900	53
		recomm. V max. <sup>2</sup>	600	61	750	47	900	53

**The tested values are air quantities determined under test room conditions in accordance with DIN EN 14175. Our experience has shown that higher air volumes may be necessary in practice. Therefore the recommended values are sometimes higher.**

When designing the ventilation system, please note that respective pressure losses must be taken into account. As a planning value, an average of approx. 100-150 Pa/fume cupboard with regulation can be assumed. An adjustment of the minimum volume flow may be necessary. Our experts will be pleased to provide you with advice and assistance during every phase of the project – talk to us.

## DELTAguard High-performance fume cupboard (DA)

### DIMENSIONS EXTERNAL AND INTERNAL

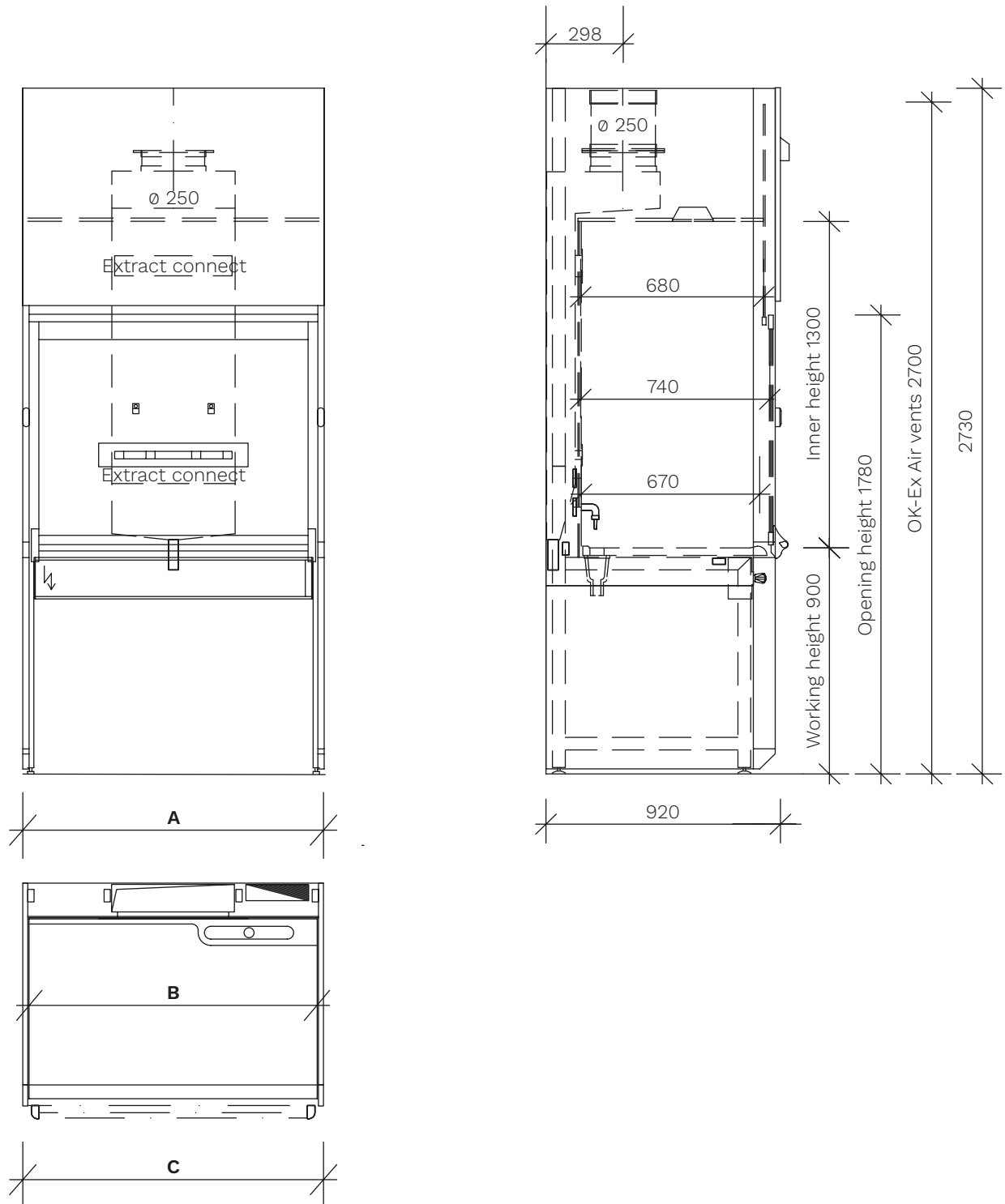

Grid width	A	1200	1500	1800
Interior width	B	1160	1460	1760
Opening width	C	1110	1410	1710

[www.wesemann.com](http://www.wesemann.com)

**Wesemann GmbH** – Headquarters

Max-Planck-Straße 15-25

28857 Syke

Germany

Telephone +49 (0) 42 42 594-0

Telefax +49 (0) 42 42 594-333

E-Mail [info@wesemann.com](mailto:info@wesemann.com)

